

TECHNICAL DESCRIPTION

REVERSE GEAR

The Volvo Penta reverse gear, type Mono Shift, has a reduction ratio of 1.91:1. The reduction gear is integrally built with the reverse gear. The power transmission from the engine to the reverse gear is via a rubber flange.

For operating "Forward" and "Reverse" the Volvo Penta patented cone clutch is used, which ensures smooth and quiet engagement. Very small forces are required to operate the reverse gear.

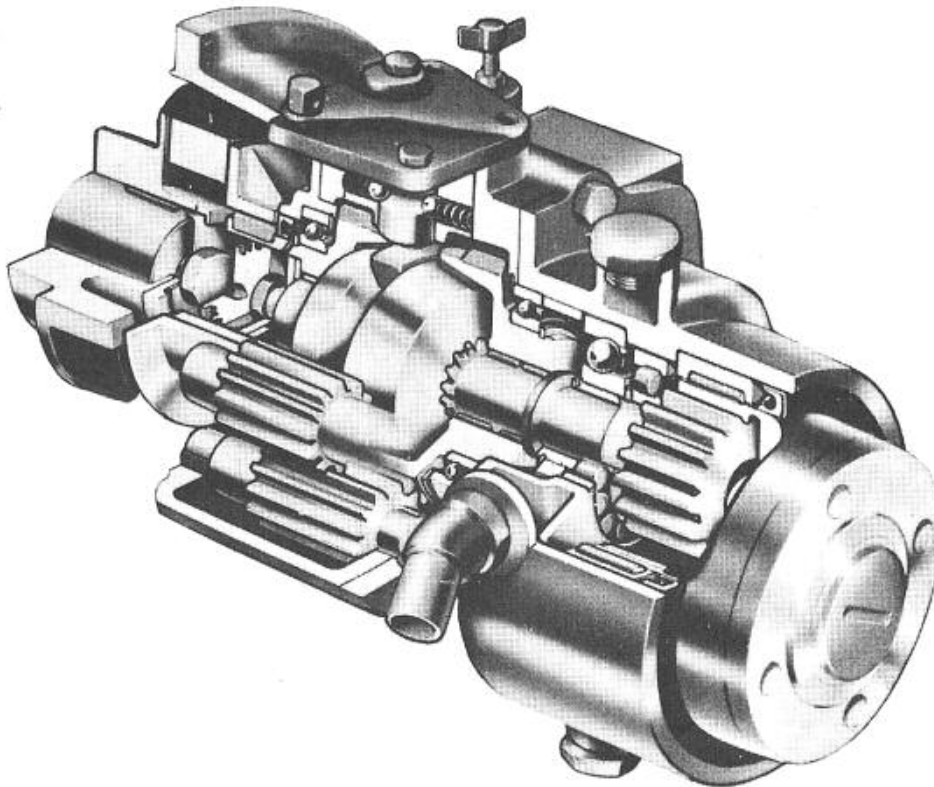

Reverse Gear type Mono Shift (MSB).

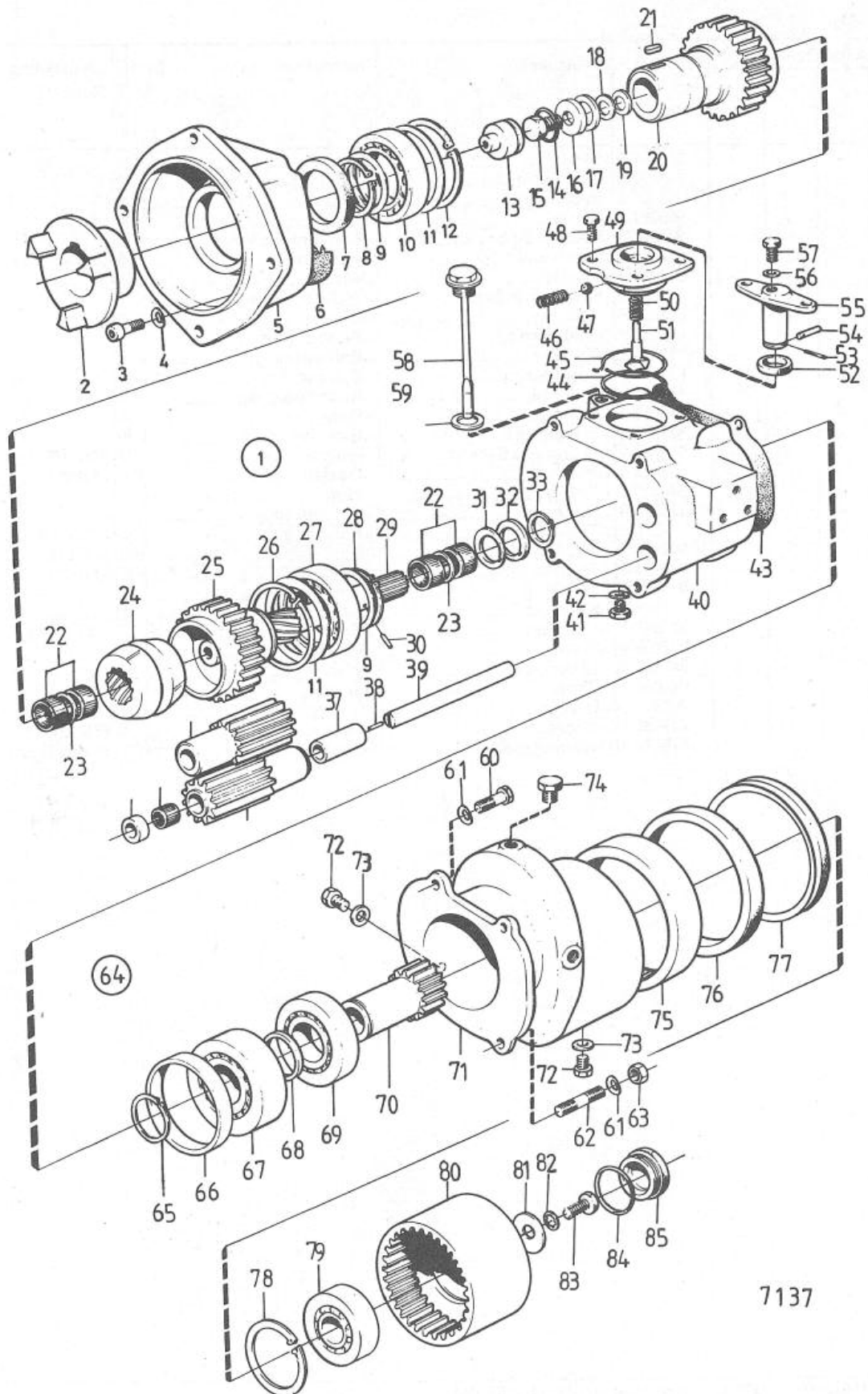

7137

Sida Page		Grupp Group		Backslag		Reverse gear		Illustration	
6		4b						7137 1984-0	
Pos. Fig.	Antal/Quantity			Artikel nr Part No	Benämning	Description	Sats Kit	B P S R	Anmärkning Notes
	833								
	860								
1	1	-	-	833860-0	Backslag	Reverse gear			UTV 1,91:1
2	1	-	-	827617-2	.Medbringare	.Carrier		5	
3	2	-	-	959223-9	.Skruv	.Screw		0	
	2	-	-	940142-3	.Skruv	.Screw		0	
4	4	-	-	941907-8	.Fjädrande bricka	.Resilient washer		0	
5	1	-	-	827584-4	.Mellanhus	.Interm housing		7	
6	1	-	-	852156-9	.Packning	.Gasket		S 2	
7	1	-	-	958878-1	.Tätningarring	.Seal ring		S 0	
8	1	-	-	914472-6	.Låsring	.Circlip		0	
9	ERF	-	-	947545-0	.Justerbricka	.Shim		0	TJ = 0,05 MM
	ERF	-	-	947546-8	.Justerbricka	.Shim		0	TJ = 0,10 MM
	ERF	-	-	947547-6	.Justerbricka	.Shim		0	TJ = 0,30 MM
10	1	-	-	183803-6	.Kullager	.Ball bearing		5	
11	ERF	-	-	947549-2	.Justerbricka	.Shim		0	TJ = 0,05 MM
	ERF	-	-	947550-0	.Justerbricka	.Shim		0	TJ = 0,10 MM
	ERF	-	-	947551-8	.Justerbricka	.Shim		0	TJ = 0,20 MM
	ERF	-	-	947552-6	.Justerbricka	.Shim		0	TJ = 0,40 MM
12	1	-	-	914540-0	.Låsring	.Circlip		0	
13	1	-	-	839629-3	.Propp	.Plug		5	
14	1	-	-	925063-0	.O-ring	.O-ring		S 0	
15	1	-	-	839673-1	.Skruv	.Screw		4	
16	1	-	-	839631-9	.Bricka	.Washer		5	
17	1	-	-	839630-1	.Bricka	.Washer		5	
18	ERF	-	-	25930-9	.Justerbricka	.Shim		3	TJ = 0,10 MM
	ERF	-	-	120073-2	.Justermellanlägg	.Shim		3	TJ = 0,50 MM
19	1	-	-	839670-7	.Bricka	.Washer		5	
20	1	-	-	839623-6	.Kuggghjul	.Gear		5	
21	1	-	-	944013-2	.Kil	.Key		0	
22	4	-	-	181268-4	.Nållager	.Needle bearing		4	
23	2	-	-	813939-6	.Distansring	.Spacer ring		5	
24	1	-	-	839628-5	.Skjuthylsa	.Sliding sleeve		6	
25	1	-	-	839625-1	.Kuggghjul	.Gear		5	
26	1	-	-	914540-0	.Låsring	.Circlip		0	
27	1	-	-	19578-4	.Kullager	.Ball bearing		5	
28	1	-	-	914472-6	.Låsring	.Circlip		0	
29	1	-	-	827589-3	.Drivaxel	.Drive shaft		5	
30	1	-	-	850761-8	.Pinne	.Pin		3	
31	1	-	-	839671-5	.Distansring	.Spacer ring		5	
32	1	-	-		.Distansring	.Spacer ring		5	
33	1	-	-	814030-3	.Låsring	.Circlip		4	
34	4	-	-	827314-6	.Bussning	.Bushing		4	
35	4	-	-	183366-4	.Nållager	.Needle bearing		4	
36	2	-	-	827312-0	.Kuggghjul	.Gear		5	
37	2	-	-	834008-5	.Distanshylsa	.Spacer sleeve		5	
38	2	-	-	951931-5	.Spännstift	.Tension pin		0	
39	2	-	-	827313-8	.Planetaxel	.Shaft		5	
40	1	-	-	827816-0	.Planethus	.Planet housing		6	
41	1	-	-	960628-6	.Propp	.Plug		0	
42	1	-	-	834452-5	.Packning	.Gasket		S 2	
43	1	-	-	827889-7	.Packning	.Gasket		S 2	
44	1	-	-	925093-7	.O-ring	.O-ring		S 0	
45	ERF	-	-	941338-6	.Låstråd	.Lock wire		0	L = 300 MM, TID UTF
46	2	-	-	839136-9	.Fjäder	.Spring		5	TID UTF
47	2	-	-	60309-2	.Kula	.Ball		5	TID UTF
48	4	-	-	955272-0	.Skruv	.Screw		0	
49	1	-	-	839505-5	.Lagerhus	.Housing		6	
50	1	-	-	814184-8	.Fjäder	.Spring		4	
51	1	-	-	839646-7	.Glidsko	.Sliding shoe		4	
52	1	-	-	958838-5	.Tätningarring	.Seal ring		S 0	(941866)
53	1	-	-	951924-0	.Spännstift	.Tension pin		0	
54	1	-	-	942871-5	.Pinne	.Pin		0	
55	1	-	-	897816-5	.Excenterkolv	.Eccentric piston		5	
56	ERF	-	-	897871-0	.Bricka	.Washer		3	TJ = 0,20 MM

Sida Page		Grupp Group		Backslag		Reverse gear		Illustration	
8		4b						7137 1984-0	
Pos. Fig.	Antal/Quantity				Artikel nr Part No	Benämning	Description	Sats Kit	Anmärkning Notes
	833	860							
57	1	-	-	-	897711-8	.SkruvScrew	4	
58	1	-	-	-	833560-6	.OljemätstickaOil dipstick	3	
59	1	-	-	-	15305-6	.PackningGasket	2	
60	2	-	-	-	955297-7	.SkruvScrew	0	SEN UTF
61	4	-	-	-	941907-8	.Fjädrande brickaResilient washer	0	
62	2	-	-	-	924062-3	.PinnskruvStud bolt	0	SEN UTF
63	2	-	-	-	955782-8	.MutterNut	0	SEN UTF
64	1	-	-	-	827664-4	.ReduktiosväxelReduction gear	7	
65	1	-	-	-	914465-0	..LåsringCirclip	0	
66	1	-	-	-	827653-7	..DistansringSpacer ring	5	
67	1	-	-	-	11025-4	..KullagerBall bearing	5	
68	1	-	-	-	827654-5	..DistansringSpacer ring	5	
69	1	-	-	-	183523-0	..RullagerRoller bearing	5	
70	1	-	-	-	827652-9	..KugghjulGear	5	
71	1	-	-	-	827639-6	..VäxelhusGear housing	6	
72	2	-	-	-	914389-2	..Propp utv 6-kantPlug	0	SEN UTF
73	2	-	-	-	834452-5	..PackningGasket	2	SEN UTF
74	2	-	-	-	946185-6	..ProppPlug	0	
75	1	-	-	-	183524-8	..KullagerBall bearing	5	
76	1	-	-	-		..TätningringSeal ring	8	2) TID UTF
	1	-	-	-	942950-7	..TätningringSeal ring	2	SEN UTF
77	1	-	-	-	947044-4	..TätningringSealring	0	SEN UTF
78	1	-	-	-	914533-5	..SpärringRetaining ring	0	
79	1	-	-	-	11023-9	..KullagerBall bearing	5	
80	1	-	-	-	827651-1	..KugghjulGear	5	
81	1	-	-	-	827659-4	..BrickaWasher	5	
82	1	-	-	-	940109-2	..LåsbrickaWasher	0	
83	1	-	-	-	959640-4	..SkruvScrew	0	
84	1	-	-	-	955998-0	..O-ringO-ring	5	SEN UTF
85	1	-	-	-	827936-6	..ProppPlug	5	SEN UTF
	1	-	-	-	875577-9	Packningssats	Gasket kit	1	SE GRUPP 10