

CHAPTER 5

INTAKE AND EXHAUST SYSTEM

1. Intake And Exhaust System.....	5-1
2. Intake Silencer	5-2
3. Exhaust System	5-3

1. Intake and Exhaust System

1-1 YSM8-R, YSM12-R

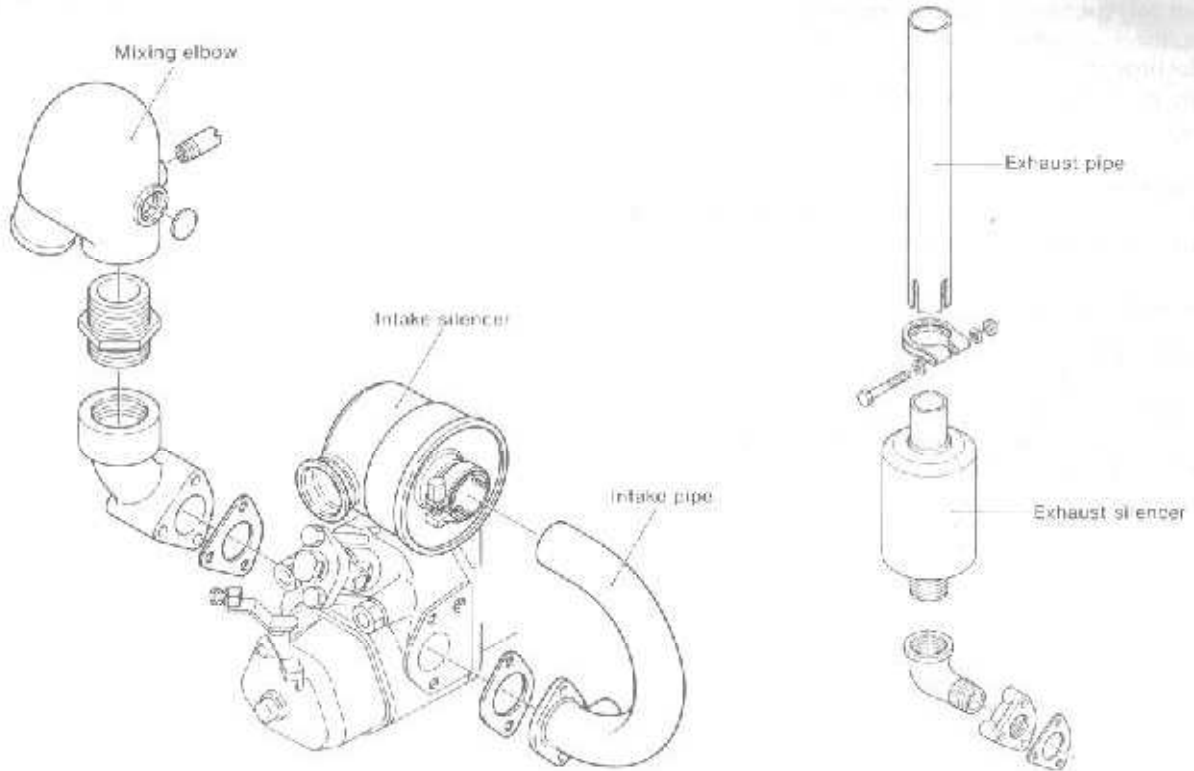

1-2 YSM8-Y, YSM12-Y

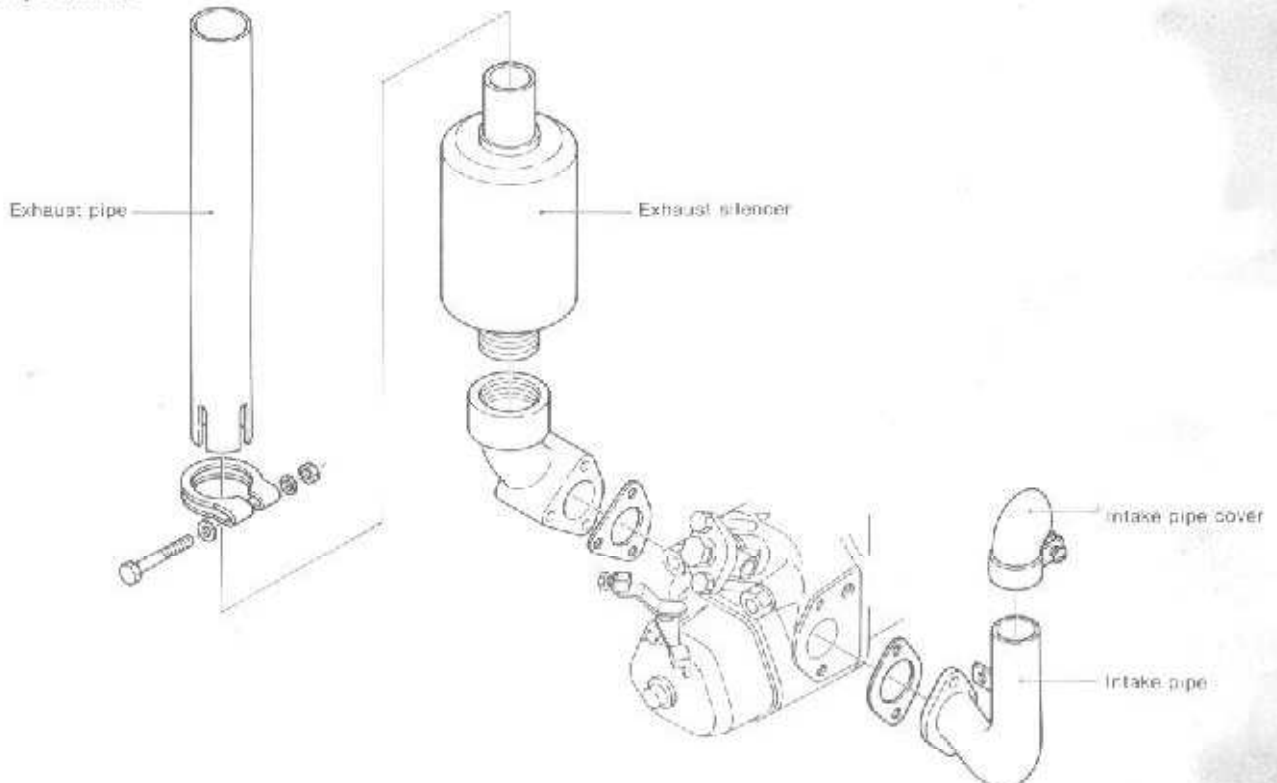

2. Intake Silencer

2-1 Construction

A round polyurethane sound absorbing type intake silencer is employed to silence the intake air sucked into the cylinder head from the intake port.

Besides providing a silencing effect, the silencer also acts as an air cleaner.

2-2 Inspection

When the intake silencer is disassembled, remove the internal polyurethane element and inspect it for clogging.

2-3 Element replacement

Replace the element as follows:

Every 300 hours of operation in dusty places

Every 500 hours of operation in ordinary places

After one year of operation even through the specified number of operating hours has not been reached.